

Ropox SlimLine Washbasin

Pre-installation information



INCLUSIVE
CARE SOLUTIONS

Electric

(40-15601, 40-15605, 40-15607)

CONSTRUCTION

The wall must be made of a material suited for screw mounting and approved for damp rooms. The hatched area is the minimum area for reinforcement of the wall.

Tested in accordance with DS/EN 12182:2012 and DS/ISO 17966:2016 with the following max. user weights:

40-15601: 165kg (363 lbs)

40-15605: 120kg (265 lbs)

40-15607: 200kg (440 lbs) (when using a porcelain wash basin)

Max. tensile load of upper screws

68kg/screw (150 lbs)

The washbasin is supplied with a set of screws and rawplugs suitable for mounting on a concrete wall. The fitter should always consider the material, condition and strength of the wall and use screws and rawplugs suitable for the specific wall type.

PLUMBING

The drain is Ø32 (1 ¼") and ends in an Ø32x88.5° drain elbow.

The water supply ends in 2 (two) 90° shut-off valves with ½" outside thread pointing downwards in an angle of 45° (not included). The maximum protrusion of the shut-off valves and drain connection should be max 77mm (3") to allow for the covers.

The optimum location and orientation is as shown.

It is important that all hoses for water connection and drain are flexible to allow the frame to move freely within the height-adjustment range of 700-1000mm (27 1/2" – 39 2/5") (including washbasin). If a different location of water supply from the recommended positioning is required and if there is a floor drain, the installation cover (40-15610) can't be used.

For purchase of adapters for connection to various standard installations, see "Connection Adapters – Other Washbasins".

POWER

Recommended location of socket in wall for optimum and hidden wiring is above unit as shown. The cable from the control unit is 2000mm (78").

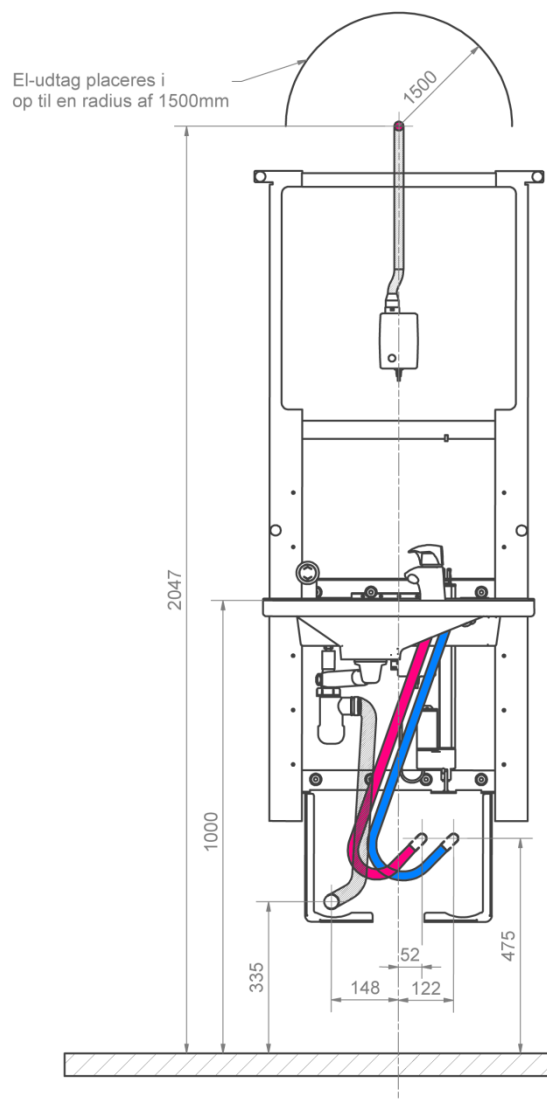
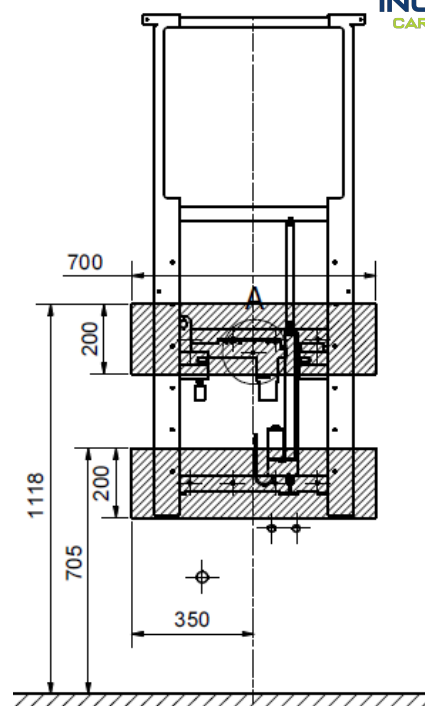

Inclusive Care Solutions

T: 03332 416 358

E: enquiries@inclusivecaresolutions.co.uk

www.inclusivecaresolutions.co.uk



INCLUSIVE
CARE SOLUTIONS